

## LED FIELD CURVEABLE COVE / INDIRECT LIGHTING

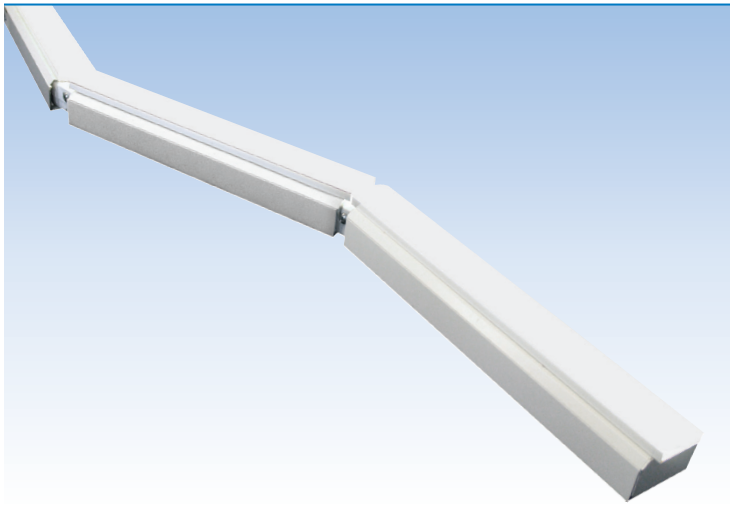

PROJECT:
TYPE:

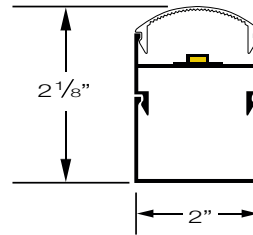

ST

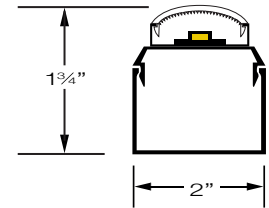

FLX

### SPECIFICATIONS

<b>HOUSING</b>	Extruded aluminum housing up to 12' long. Continuous runs available.
<b>FINISH</b>	Satin anodized or white paint finish standard. Custom finish optional.
<b>LENS</b>	Extruded DR acrylic, snap-on frosted widespread lens.
<b>LED DRIVER</b>	Integral, universal voltage; 0-10V dimming standard; 1% or 10% dimming.
<b>MOUNTING</b>	<b>SURFACE MOUNT:</b> Mounting holes pre-drilled. See page 2 for details. <b>CABLE SUSPENDED:</b> Aircraft cable suspension kit (SK), canopy and prewired with 18/5 SVT cord.
<b>LED's</b>	60,000 hours. (L70), High uniformity, 80 CRI
<b>CERTIFICATION</b>	ETL/CSA listed for damp locations.  2001431  MADE IN THE USA

### LED COLOR & LUMEN OPTIONS

4' – 24" BOARDS		LUMENS PER FOOT – WATTS PER FOOT – LUMENS PER WATT								
LED COLOR	CRI	LOW			MEDIUM			HIGH		
WHITE 2700K	80	500 L/FT	3.5 W/FT	136 L/W	870 L/FT	6.5 W/FT	130 L/W	1160 L/FT	9.0 W/FT	127 L/W
WHITE 3000K	80	530 L/FT	3.5 W/FT	144 L/W	915 L/FT	6.5 W/FT	137 L/W	1220 L/FT	9.0 W/FT	133 L/W
WHITE 3500K	80	535 L/FT	3.5 W/FT	144 L/W	920 L/FT	6.5 W/FT	137 L/W	1225 L/FT	9.0 W/FT	133 L/W
WHITE 4000K	80	560 L/FT	3.5 W/FT	151 L/W	970 L/FT	6.5 W/FT	145 L/W	1290 L/FT	9.0 W/FT	140 L/W

Higher lumen packages available.

### CONFIGURATION



ST - STRAIGHT

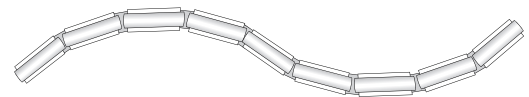

FLX - FLEXIBLE, FIELD CURVEABLE

### PART NUMBER

SERIES	LUMENS	COLOR	VOLTS	CONFIGURATION	FINISH	LENGTH
ALX2-LP	L LOW	27K 2700K	120V/277V	ST STRAIGHT	S SATIN	SPECIFY
	M MEDIUM	3K 3000K	UNV 1 1% DIM	FLX FIELD CURVEABLE	W WHITE	
	H HIGH	35K 3500K	UNV 10 10% DIM		C CUSTOM	
	CP CUSTOM PROGRAMMED (Specify Lumens/FT or Watts/FT)	4K 4000K				

## QUICK LIGHTING GUIDE

### CEILING COVE LIGHTING

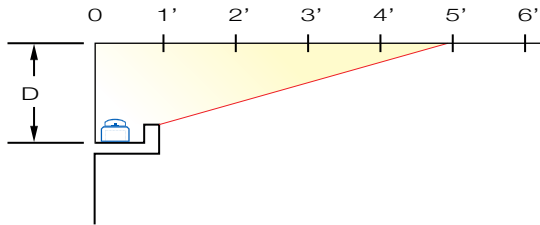

### CEILING COVE FOOTCANDLES

D	1'	2'	3'	4'	5'	6'	7'	8'	9'
12"	68	13	3.5	1.9	1.0	0.8	0.7	0.6	0.6
18"	68	21	8.6	3.1	1.9	1.0	0.8	0.7	0.7
24"	63	26	11	5.9	2.5	1.7	1.2	1.0	0.7
36"	44	30	17	7.2	4.3	4.0	2.8	1.5	1.2

Calculation using "LOW" lumen board; 385L x 3500K

### WALL LIGHTING

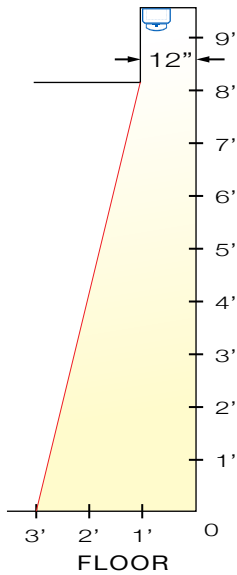

### WALL WASH COVE FOOTCANDLES

	1'	2'	3'	4'	5'	6'	7'	8'	9'
WALL	2.1	2.4	2.9	3.8	5.3	7.8	12	27	57
FLOOR	1.5	2.1	2.2	2.1	2.1	1.8	1.6	1.0	0.8

Calculation using "LOW" lumen board; 385L x 3500K

### CONVERSION CHART

LUMENS	27K	3K	35K	4K
LOW	.90	.96	1	1.06
MEDIUM	1.75	1.86	1.97	2.05
HIGH	2.05	2.11	2.57	2.64

## RADIUS, COVE & FIXTURE DIMMENSIONS

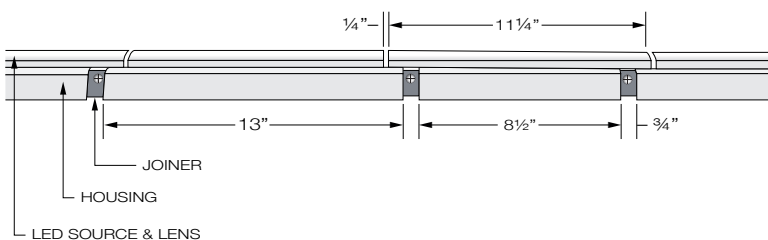
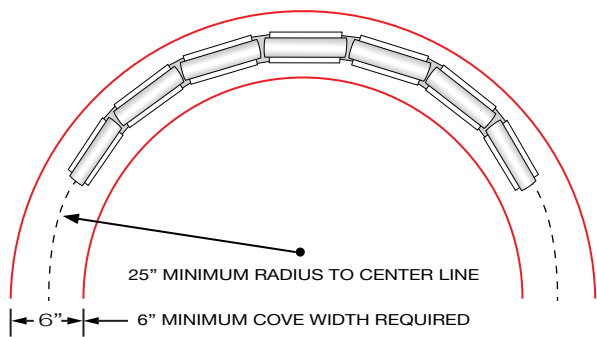

## PHOTOMETRICS

FILE NAME: L10137801R01.IES

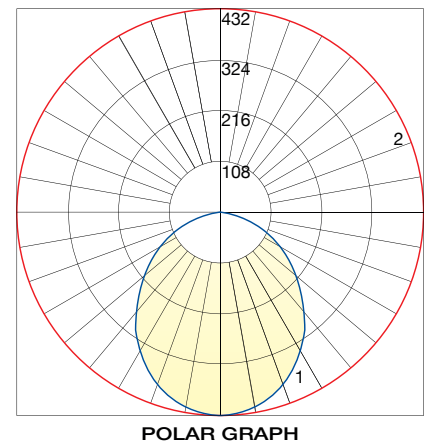

Maximum Candela = 432

Located at Horizontal Angle = 0 Vertical Angle = 0

#1 – Vertical Plane through Horizontal Angles (0–180) (Through Max. Cd.)

#2 – Horizontal Cone through Vertical Angle (0) (Through Max. Cd.)